

CEDARWAY DOUBLE UTILITY TRIM SPECIFICATION

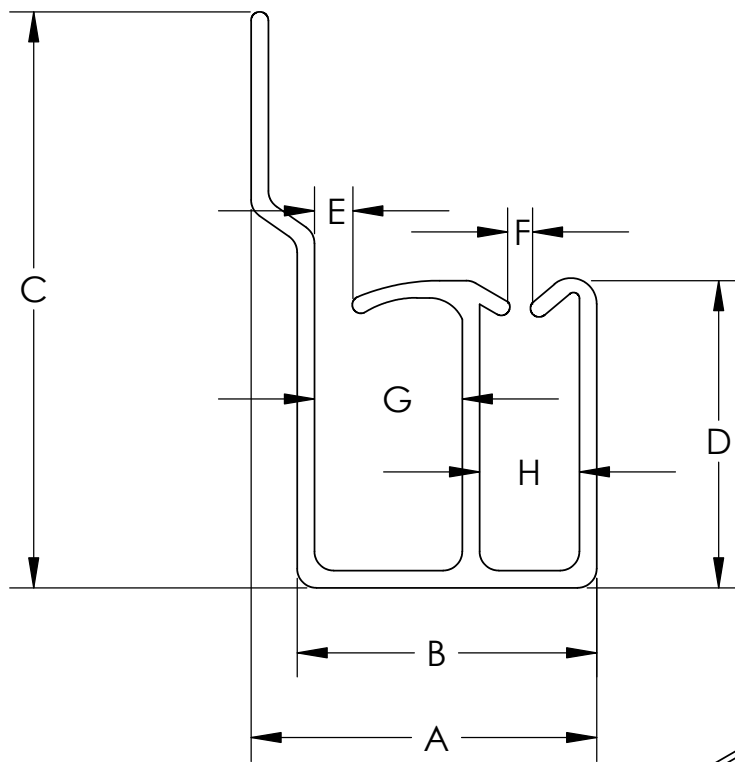

- A. UTILITY TRIM TOTAL WIDTH = 15/16"
- B. UTILITY TRIM J CHANNEL WIDTH = 3/4"
- C. TOTAL HEIGHT = 1 1/2"
- D. EXPOSED J-CHANNEL HEIGHT = 13/16"
- E. FIRST GAP WIDTH = 1/8"
- F. SECOND GAP WIDTH = 1/16"
- G. FIRST J-CHANNEL INSIDE WIDTH = 3/8"
- H. SECOND J-CHANNEL INSIDE WIDTH = 1/4"
- I. TOTAL LENGTH = 12' SECTIONS
- J. NAIL HOLE LENGTH = 1"

WALL THICKNESS EXPOSED = 0.045"

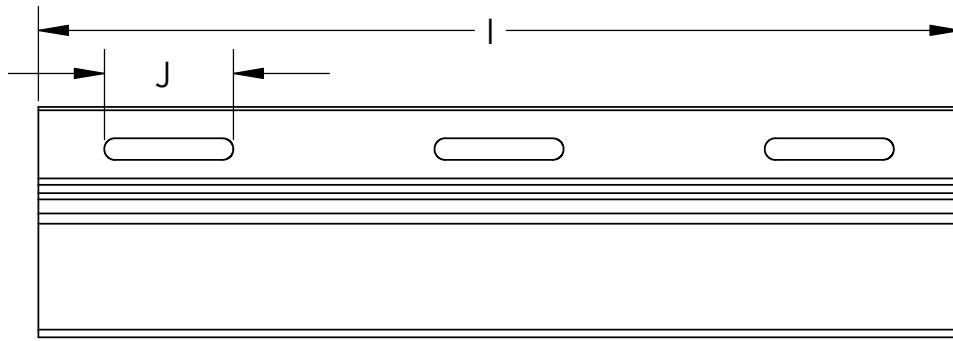