

CEDARWAY FLEXIBLE J CHANNEL SPECIFICATION

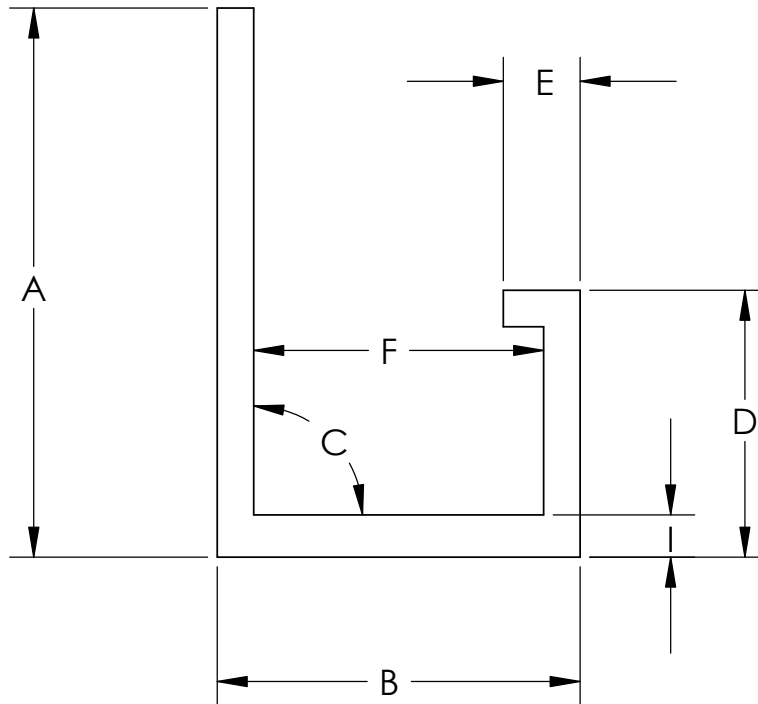

- A. TOTAL HEIGHT = 1 7/16"
- B. TOTAL WIDTH = 1"
- C. CORNER ANGLE = 90°
- D. EXPOSED J CHANNEL HEIGHT = 3/4"
- E. EXPOSED TOP LIP = 1/4"
- F. INSIDE J CHANNEL WIDTH = 3/4"
- G. TOTAL LENGTH = 12' 6" (150") SECTIONS
- H. FLEX SLIT LENGTH = 3/8"
- I. WALL THICKNESS = 1/8"

WALL THICKNESS (UNLESS NOTED) = 3/32"

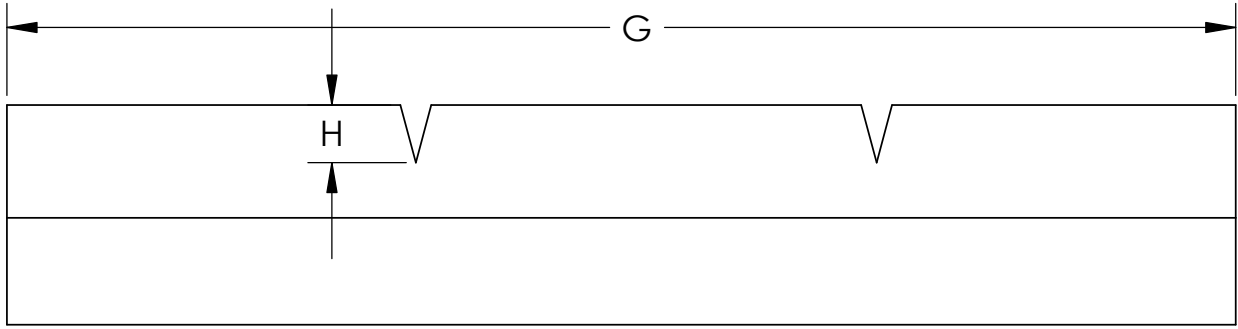