

CEDARWAY "N" VERSION TRADITIONAL SHAKE SPECIFICATION

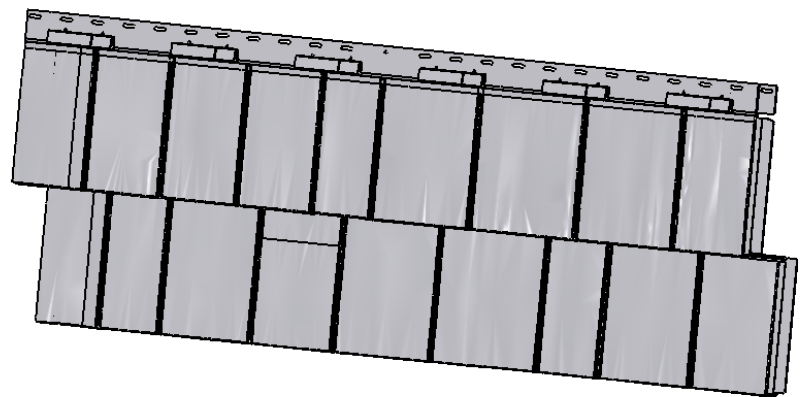
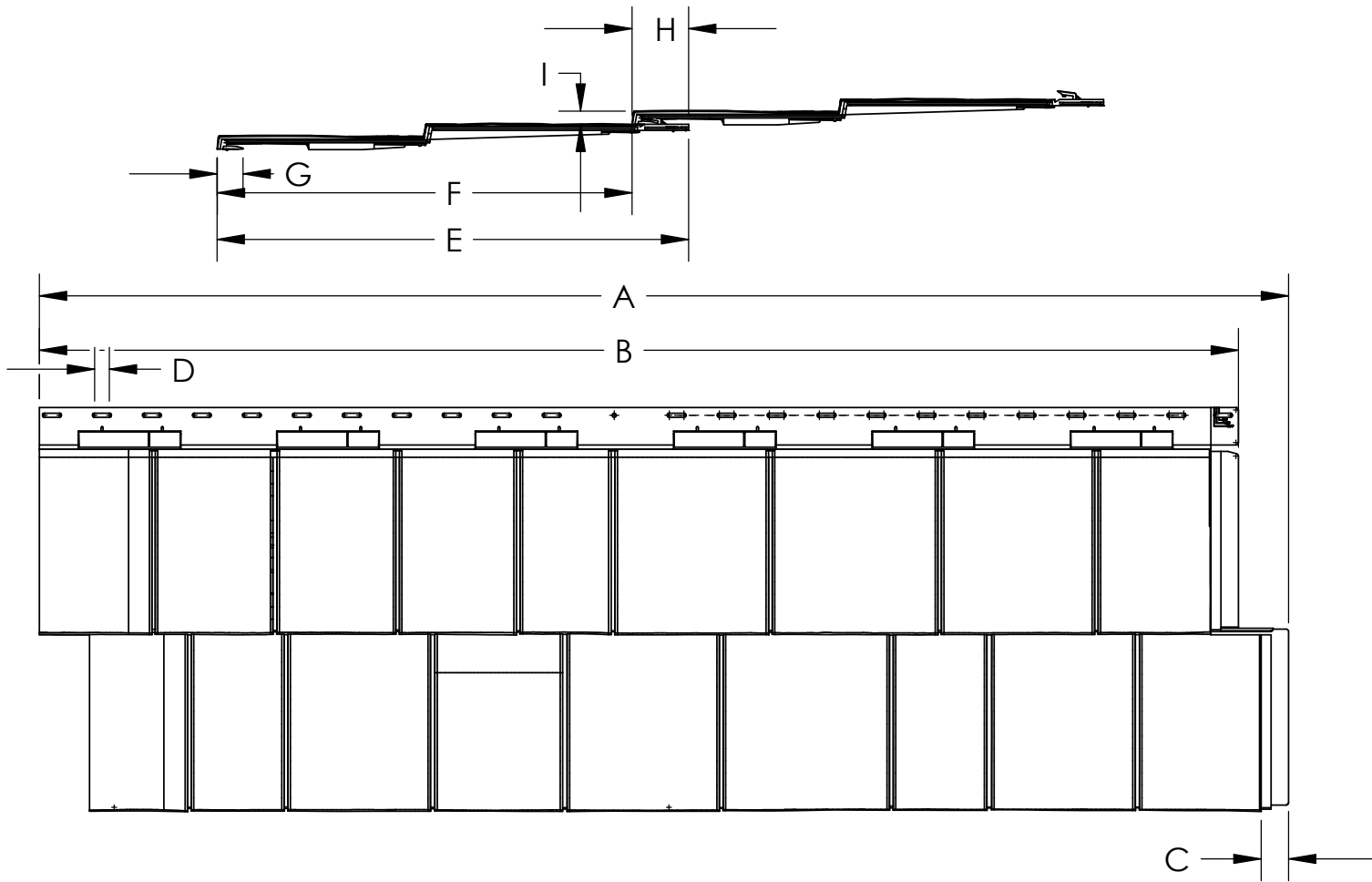

- A. TOTAL PANEL LENGTH = 50"
- B. EXPOSED PANEL LENGTH = 47 3/4"
- C. END TAB = 1"
- D. NAIL SLOT CENTER TO CENTER = 1/2"
- E. TOTAL PANEL WIDTH = 16 1/8"
- F. INTERLOCKED PANEL WIDTH = 14 1/4"
- G. BUTT J-CHANNEL LENGTH = 7/8"
- H. LOCK AND NAILING FLANGE = 1 15/16"
- I. INSTALLED BUTT HEIGHT = 5/8"

WALL THICKNESS EXPOSED = 0.10"

WEEP HOLE = 3/16"

PALLET SIZE = 55" X 40"